

HD78/F

Event-Driven Indoor Security IP Camera/Detector

Installation Manual V1.0



Introduction

The HD78/F Event-Driven Indoor Security IP Camera combined with its Security Detector provide video/audio solution for security systems. It provides day/night vision at 720P and Hi-Fi audio recording, with over 40 minutes of internal event-recording capacity.

Installing the HD78

Unscrew and remove cover



Mount back on wall or bracket

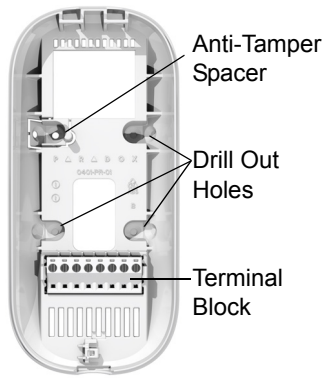

Bracket Mount

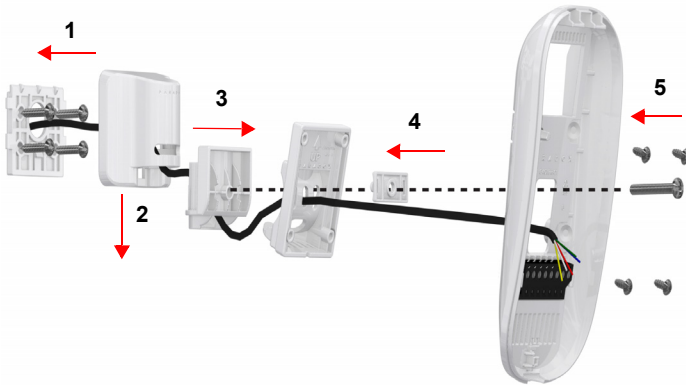

HD78F - Connect Via Wi-Fi with Insite App

HD78 - Bus Wiring and / or Ethernet (HD78)

Wiring Using a CAT5e Cable

Wire the HD78/F camera with a single CAT5e or higher cable including two twisted pairs for the 4-wire bus and two twisted pairs for the Ethernet lines. The maximum CAT5e cable length is 50 meters.

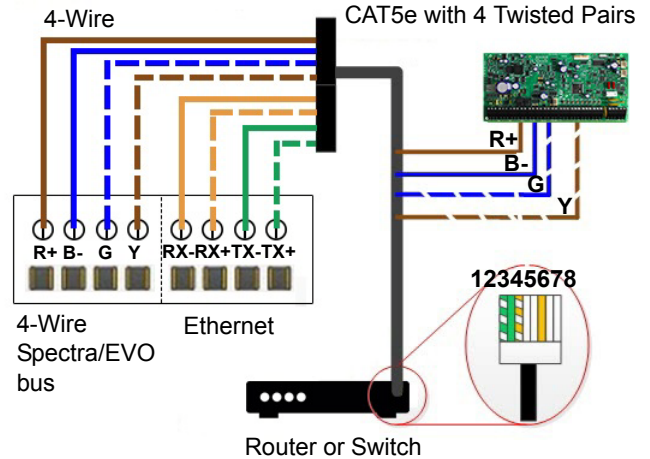

Recommended Wiring Assignment		Ethernet Connector	
Bus Label	Wire Color	Ethernet Wire Assignment	Wire Color
R+	Brown	1	Green Striped
B-	Blue	2	Green
G	Blue striped	3	Orange Striped
Y	Brown striped	4	
RX-	Orange	5	
RX+	Orange striped	6	Orange
TX-	Green	7	
TX+	Green striped	8	

Programming

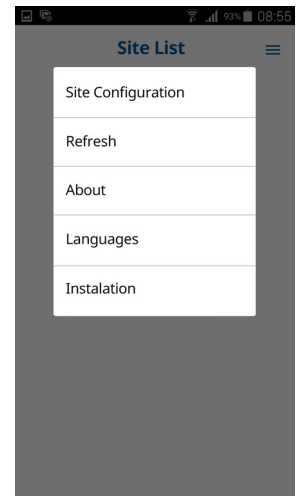

Connect Power, Open Tamper

1. HD78F - Activate hotspot on your Android device.
2. HD78/F - Launch the Insite App.
3. Go to menu, select installation.
4. Follow screen instructions.



LED Status Indicators

Other than PIR detection, LEDs are active when lock mechanism is open.

LED	Functionality	LED Display
TX	Digiplex/Spectra Data TX	Flashing green: Data transmission Off: No data transmission
RX	Digiplex/Spectra Data RX	Flashing green: Data reception Off: No data reception
	Firmware upgrade in progress.	Flashing purple
	VOD*	Blue on
	Power-up	Flashing blue
	Locate mode	Flashing blue
	No connection to panel bus	Flashing red
	Bus low power	Flashing red
	PIR detection	Red on for 3 seconds
	Active Wi-Fi	Green on
	LAN 10/100Mb link	Green on: LAN active

*VOD On/Off LED is controlled by the Master **ONLY**, using the Insite GOLD application.

PIR Detector Beam Patterns

Top View

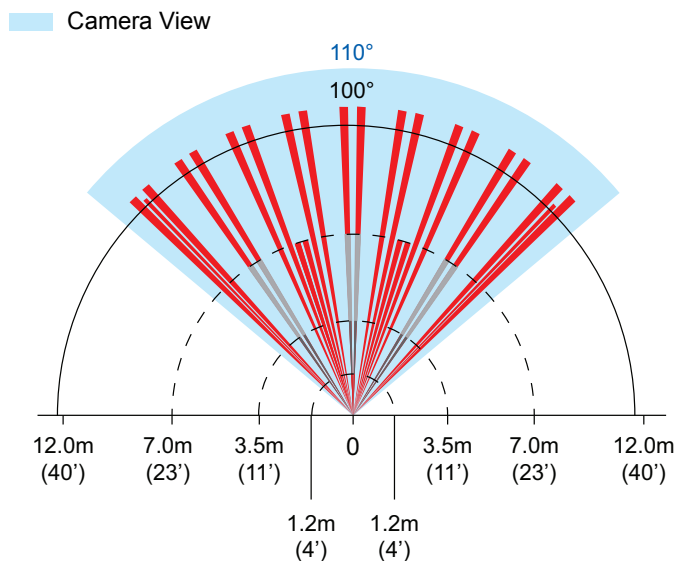

Side View

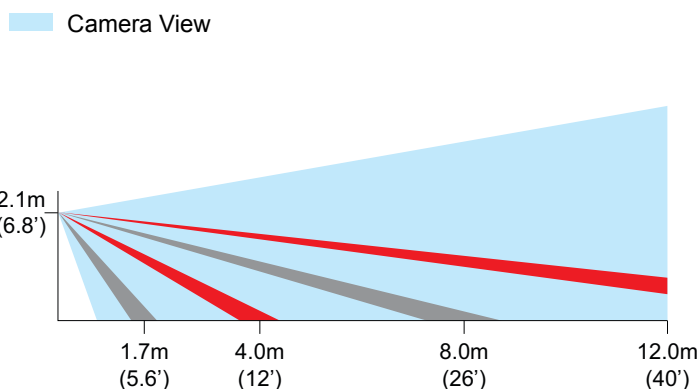

Technical Specifications

Voltage Input	Nominal: 12VDC, range 9-16VDC
Current Consumption Max	350mA Max - IR illumination ON 250mA Nominal - IR illumination OFF Battery operation - 100mA
PIR Type	Quad PIR, auto pulse, dual edge, digital detector
Dimensions / Weight	H x W x D: 15 x 7.1 x 6cm (6 x 2.8 x 2.4in) / 163g (5.75oz)
Operating Temperature	-20° C to +40° C (-4° F to 104° F)
Compliance	EN 50131-2-2 Grade 2 Environmental Class II
Installation Height	2.1m - 2.7m (7ft - 9ft)
Compatibility	SP5500, SP6000 and SP7000

Warranty

For complete warranty information on this product, please refer to the Limited Warranty Statement is found on the website: www.paradox.com/terms or contact your local distributor. Specifications may change without prior notice.

Patents

US, Canadian and international patents may apply. Paradox is a trademark or registered trademark of Paradox Security Systems (Bahamas) Ltd.